

Online Application Flow

Notes for applicants who are residents outside of Japan.

- It is possible to see the online application website and register from overseas, however please enter your personal information only in Japanese or English on "My Page."
- Applications received after the deadline will not be accepted even if it is from overseas. Please make sure to submit the application documents well in advance of the deadline.

The entire flow of application procedures is as follows.

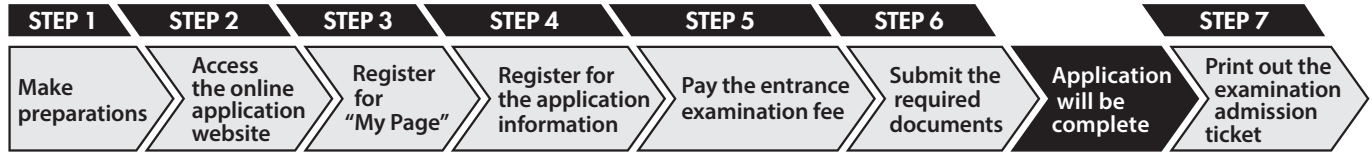

STEP
1
▽
▽

Make preparations

Please prepare a PC with the Internet connected, and a printer.
It may take time for the required documents* to be issued. Please start your preparation early, and ensure that you have all of them in hand before applying.

*Required Documents ... A school report, facial photo data, etc.
For details, refer to the Page ● of the application guidelines.

A school report

A score request form for the unified university entrance exam

Facial photo data

STEP
2
▽
▽

Access the online application website

Access from the Online Application website
▶ <https://e-apply.jp/ds/iwate-pu-gs>

or

the University website
▶ <https://www.iwate-pu.ac.jp/examination/index.html>

STEP
3
▽
▽
▽

Register for "My Page"

According to the instructions on the screen, enter the required information to register for "My Page".
If you have already registered, proceed to STEP4.

① If you register for the first time, log in from **My Page Registration**

② Register your e-mail address and click on **Send an e-mail for temporary registration**

③ Click on **To log-in page** from the user registration screen.

④ A default password and URL for the definitive registration will be sent to the e-mail address you registered.

*Configure your e-mail settings to receive e-mails from the domain of "@e-apply.jp".

⑤ On the log-in screen, fill in your registered e-mail address and the "default password" you received in step ④, and click on **log-in**

⑥ Change your default password.

⑦ Enter your personal information and click on **Next**

⑧ Confirm your personal information and click on **Register this information**



Pay the entrance examination fee

2 3 4 ... The method is limited to people residing in Japan

1 Credit Card Payment

You can select this method and make a payment when registering the application information.

[Credit Cards Accepted]

VISA, Master, JCB, AMERICAN EXPRESS, MUFG Card, DC Card, UFJ Card, NICOS Card



Payment can be completed upon registration.

2 Online Banking Payment

After registering your application information, you will be redirected to another page of each financial institution from your current page. Please follow the instructions on the screen to make the payment.

*For online payment, your bank account for settlement requires an online banking service agreement.

The procedures are complete on the Web.

3 Payment at Convenience Store

If you make payment at a convenience store, a payment number is necessary. The number will be available after you register the application information.

● Payment is acceptable at a cash register.

● Payment is acceptable at convenience store terminal.



Loppi



Multi-functional copy machine

あなたも、コンビニ。 FamilyMart



4 Pay-easy compatible ATM

If you make payment at a payment number is necessary. The number will be available after you register the application information. Please keep that number and make payment by following the instructions at Pay-easy compatible ATMs.



*For banks that accept this payment method, please check the "Payment Method Selection" screen.

Follow the instructions on the screen of each convenience store terminal or ATM to enter the necessary information and confirm the details before paying the entrance examination fee.

3 Convenience Stores

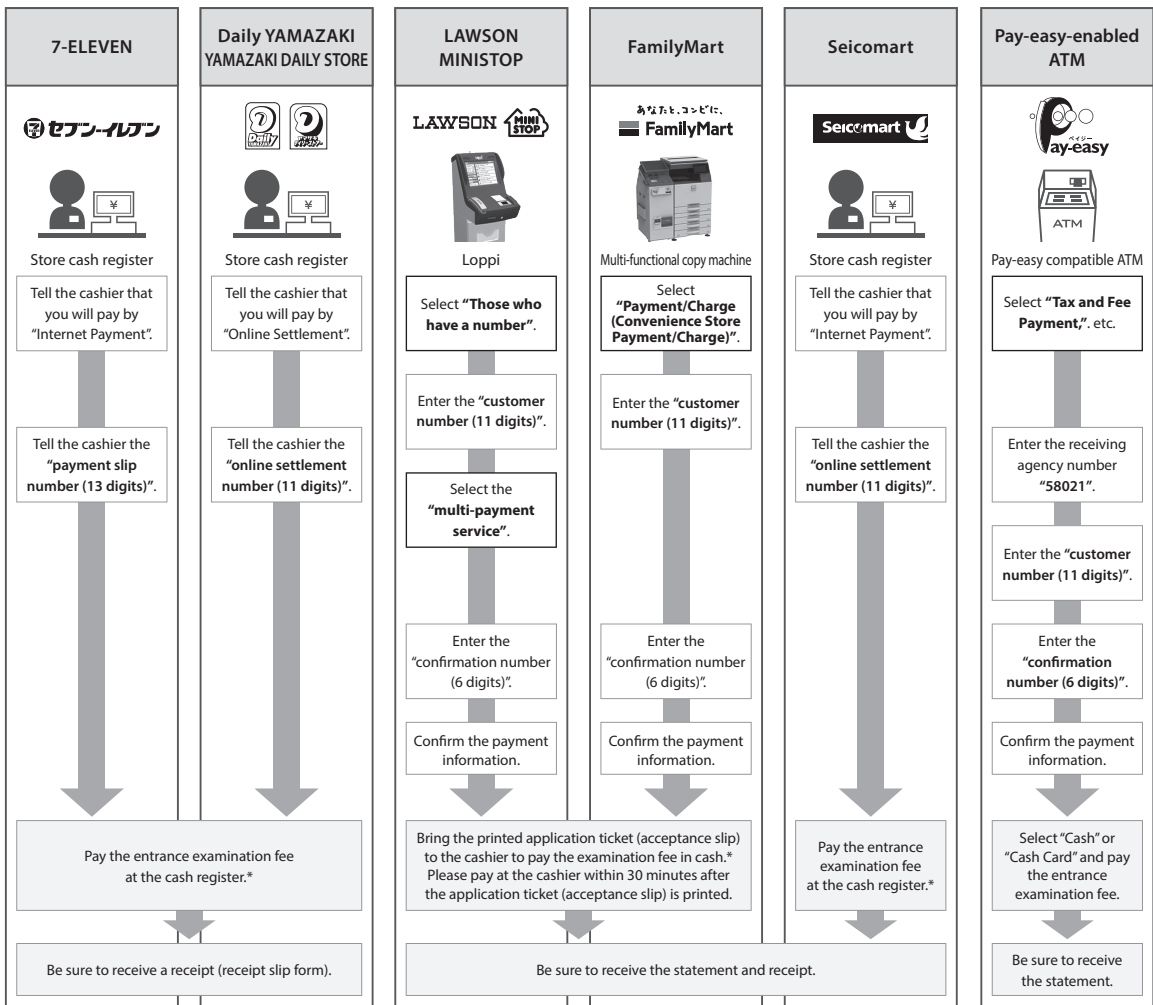

*When using an ATM of Japan Post Bank or banks, you need to pay using a cash card if the amount exceeds 100,000 yen. When using a convenience store, you can pay up to 300,000 yen in cash.

STEP

6



Print and Submit the required documents

Please note that registration alone does not complete the application procedures.

After completing the registration for application and the payment of the entrance examination fee, print out the downloadable documents, and mail them with all the other required documents by simple registered express mail from a post office, or bring them with all the other required documents to university within the application period.

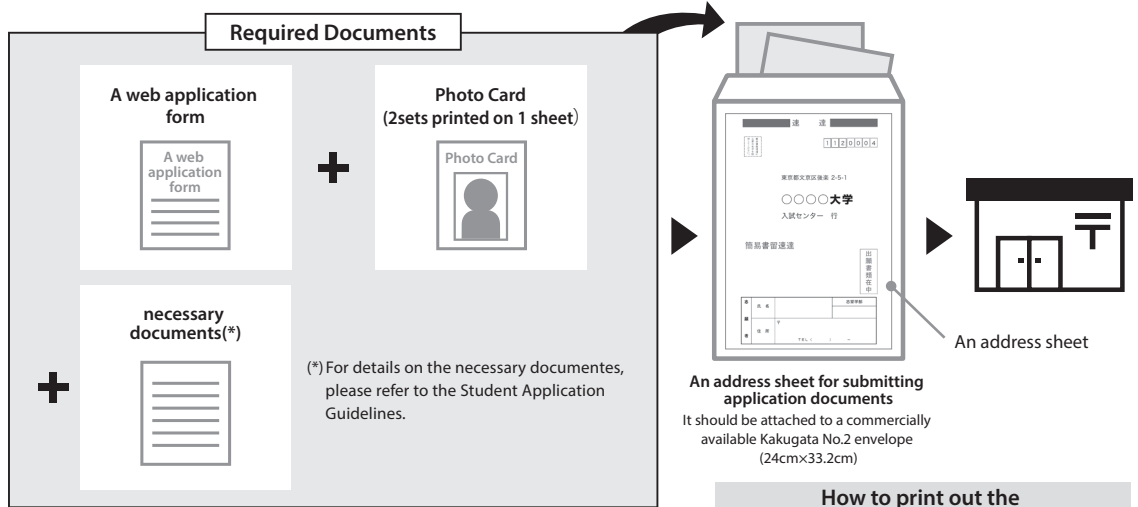

Addressee

The shipping address will be printed on the address sheet automatically.

Application Documents

For details, please check "Application Documents" in the application guidelines.

*Once received, the entrance examination fee will not be refunded, nor will any of the required documents be returned.

- (1) Click on the **Application Form (Print)** button shown on the My page.
- (2) Once the payment has been successfully completed, you will be able to click on the **Application Form (Print)** button to print out the web application form.

<Application is completed.>

Notes for submitting the application

Your application will be completed by paying the entrance examination fee and mailing or bring to university the required documents to university after completing the registration on the online application website. Please note that, even if you complete the registration, your application will not be accepted when the required documents are not received by the application deadline.

Online application is available 24 hours a day. However, the registration for application must be completed by 16:00 on the application deadline date. For details, please check "Application Documents" in the application guidelines.

STEP

7



Print the examination admission ticket

After your application is confirmed by the university, the examination admission ticket will be distributed all at once for each entrance examination, from the end of the application period to the day before the examination. It will be downloadable from the online application system. Please make sure to print it out and bring it with you on the day of the examination (*The examination admission ticket will not be mailed to applicants).

When the examination admission ticket is ready for download, an e-mail notification will be sent to your registered e-mail address.

[Important Points of Printing]

The examination admission ticket must be printed single-sided on A4 paper.



An examination admission ticket

Name : OOOO
Entrance Examination :
XXX Entrance Examination